

Downtown
Office
FOR LEASE



Opportunity in
heart of downtown
Lawrence

911 Massachusetts Street

Lawrence
Kansas



Property Description

- Prime location at 9th and Massachusetts St. (Equivalent to Main Street)
- Excellent space for office, studio, group classes
- In heart of historic downtown, near one of the busiest corners.
 - National retailer presence
 - Specialty local shops
 - Top tier restaurants
- Convenient parking with alley access and 500+ city garage nearby.



Property Highlights

- Unit size: Various
- Accessible restrooms
- Zoning: Commercial Downtown
- Year Built: 1966, renovated 1994
- Lease Type: Full Service
- Lease Rate: \$7-\$8 / foot

AGENT:

Evan Holt
(785)640-8923
evanholt@stephensre.com

John Salvino
(785)760-0638
johnsalvino@stephensre.com

BROKERAGE:

Stephens Real Estate
2701 W. Sixth Street
Lawrence KS, 66049
www.Commercial.StephensRE.com

911 Massachusetts

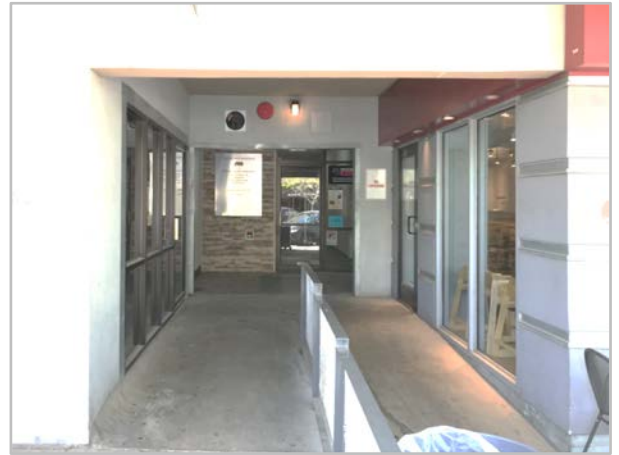

Entryway

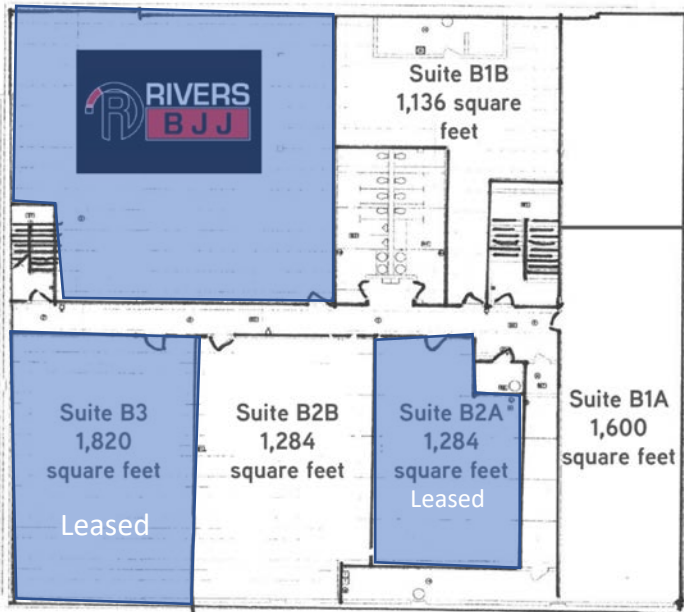

Elevator & Hallway

B1A	B1B	B2A	B2B	B3	B4
Available	Available	Occupied	Available	Occupied	Occupied
@ 1,660 feet	@ 1,136 feet	@ 1,284 feet	@ 1,284 feet	@ 1,820 feet	@ 3,136 feet
\$1,066 monthly	\$757 monthly		\$1,284 monthly		